

STARCRAFT
THE FUTURE OF CAMPING | pure and simple.

AR-ONE 7' & 8' WIDE TRAVEL TRAILER, TOY HAULER & FIFTH WHEEL

TAKES YOU TO OTHER WORLDS OF VALUE AND ENJOYMENT. **AR-ONE**



AR-ONE. YOUR ONE SOURCE FOR A SINGLE LIGHTWEIGHT MODEL LINE WITH MUCH MORE SELECTION.



AR-ONE TRAVEL TRAILER.

This is the best value in lightweight travel trailers! The AR-ONE 7'-wide travel trailer line is an entry-level camper that is priced right, yet comes with many quality features. Key features are bolder exterior graphics, honey-glazed cherry wood cabinetry and genuine Denver Mattress® brand ultra plush bunk mats. A 2-year limited warranty is still standard as well! With a lot of quality and time-tested features packed into a small, lightweight camper, the AR-ONE includes user-friendly amenities to help ensure an enjoyable camping experience. And many of these AR-ONE floorplans are towable by SUVs and minivans.



AR-ONE MAXX TRAVEL TRAILER.

The AR-ONE MAXX line features an 8'-wide body and plenty of top-quality standard amenities. Solid ball-bearing drawer guides, brand name appliances and Denver Mattress® brand bunk mats are among the many standards you'll find. A 2-year limited warranty also sets the Starcraft brand apart. With 11 floorplans, you'll find a variety of layouts, including double-over-double bunk beds, a front and rear queen bed design, and additional bunk bed models (for the family campers), along with plenty of storage in this lineup. Packing a lot into a lightweight travel trailer, the AR-ONE MAXX will provide years of use.



AR-ONE AND MAXX TOY HAULER.

New for this model year, AR-ONE offers several 7'-wide and 8'-wide toy hauler floorplans. For those on the go, and wanting to take golf carts, ATV's, pets and hobbies along; the extra "garage" space will accommodate. AR-ONE toy haulers feature over 8' of cargo room while the MAXX toy hauler provides over 14' of usable space. Fold-down bunks, in-floor tie-downs, ramp door and fold-up sofas are all unique features of these toy haulers. Model 17XTH even comes with an expandable bed for maximum use of living space. With all of the quality features of the AR-ONE series, take one of these toy haulers on your next adventure!



AR-ONE MAXX FIFTH-WHEEL.

Get the MAXX out of your RVing experience with one of these all-new AR-ONE MAXX fifth wheels. And as with many other models of the AR-ONE line, standard features include fiberglass front cap, electric awning with LED lighting, black front diamond plate, Magnum Roof System, LED interior lighting, and many more features including a long list of optional accessories. For more information on the AR-ONE fifth wheel, see your authorized Starcraft dealer or visit www.starcraftcamping.com today.



SEE THE FULL COMPARISON ONLINE AT STARCRAFTCAMPING.COM



US Vertical wood studs for added support.



THEM Little aluminum brace, if that.



US 4,500 lbs. on a Starcraft roof!



THEM Same weight on a competitor's style roof.



US We use large oversized nail plates on both sides.



THEM They use smaller and only on one side of truss.

STRONGEST ROOF EVER!

Strength is one of the basic principles of engineering; the stronger something is built, the longer it will last. At Starcraft, we understand strength comes from within, which is why we focused on the smallest of details when constructing our exclusive Magnum Roof System. From sturdier vertical studs to 7" header beams, we pride ourselves on staying at the top of our game building stronger products that last.

For over 50 years Starcraft RV's reputation has been built around top-quality products. Each is designed to provide years of trouble-free use. Backed by a 2-year limited warranty, our innovation and quality start with a solid foundation. Compare and you'll see just how much care and meticulous attention to "doing it right" goes into every Starcraft.



Our optional Climate Package extends your camping season, providing protection against cooler temperatures with its insulated, heated and enclosed underbelly.

AR-ONE 7' WIDE TRAVEL TRAILER



18QB with Pecan interior.



18QB with Pecan interior.



Star-slide dinette sofa/sleeper.



Large bathroom.



Electric awning.

AFFORDABLE VALUE. WITH SUPERIOR QUALITY.

LIVING ROOM.

Standard features include vinyl flooring for ease of cleaning, convertible dinette, arched ceiling design, air conditioner and more. See page 7 for more standards and optional items.

KITCHEN.

Even for a lightweight, affordable travel trailer, you'll find the conveniences of home: large sink, 2-burner cooktop, microwave, power range hood and plenty of countertop space for food preparation.

BEDROOM.

Perfect for family camping and sleeping, AR-ONE 7'-wides come with ultra plush Denver Mattress® bunk mats.

BATHROOM.

A foot-flush toilet, sink with mirror, shower vent and tub/shower surround are all standard equipment with AR-ONE. See floorplans for bathroom configurations.



AR-ONE 7' WIDE TOY HAULER



17XTH Toy Hauler with Pecan interior.



17XTH



Bunk beds.



17XTH



AFFORDABLE TOY HAULERS.

The AR-ONE 7'-wide toy hauler models are an economical choice for the adventurous. The folding sofa/sleeper and expandable offer more sleeping capacity. The ramp door is sturdy and secure, plus there are floor tie-downs mounted to the frame.

POPULAR STANDARDS

- Cable-support bunk-end system (1,100-lb. capacity) (15RB, 18FB)
- Crowned truss roof rafters on 16" centers with WALK ON decking
- Magnum Roof System - 50% Stronger
- 77" Crowned interior roof
- 78" Ceiling height (17TH & 17XTH)
- AquaShield Aqualon water-repellent sectionalized tent with 7-year warranty (15RB, 18FB)
- Cable TV prep
- Digital antenna (TV/FM)
- Front window with flush-mounted stone guard (select models)
- Galvanized steel wheel wells
- Three-toned exterior metal
- 3 cu. ft. gas/electric refrigerator
- Ultra plush Denver Mattress® bunk mats
- Skylight in tub/shower

CUSTOMER CONVENIENCE PACKAGE (MANDATORY)

SHOW STOPPER PACKAGE (MANDATORY)

- Electric awning
- Spare tire with carrier
- Smooth front wall
- Solar prep
- Foot-flush toilet

POPULAR OPTIONS

- 13,500-BTU A/C in lieu of 5,000 or 8,000-BTU A/C
- Heated bunk mats
- Bedspread
- Retractable screen wall (17TH & 17XTH)
- Extreme Package: 5" extra ground clearance, 6-sided Flexfoam® insulation, 15" off-road mud tires, double entrance step, enclosed underbelly, fender flair
- Performance Package (17TH & 17XTH): ToyLok®, 12 volt air station, glow-in-the-dark graphics, battery disconnect switch

FOR FULL OPTIONS AND MORE STANDARD FEATURES GO TO starcraftcamping.com

SPECIFICATIONS

	14RB	15RB	16BH	17RD	17TH	17XTH	18BHS	18FB	18QB
Unloaded Vehicle Weight (lbs.)	2509	2682	2680	2958	3524	3656	3235	3075	3071
Dry Hitch Weight (lbs.)	255	220	335	305	455	430	359	325	335
Gross Vehicle Weight Rating (lbs.)	3200	3200	3500	3500	5500	5500	3950	3750	3750
Cargo Carrying Capacity (lbs.)	651	478	780	502	1936	1804	695	635	639
Exterior Length	16' 6"	17' 6"	17' 10"	20' 6"	20' 10"	20' 10"	21' 11"	21' 6"	21' 8"
Exterior Width	85"	85"	85"	85"	86"	86"	85"	85"	85"
Exterior Height with A/C	117 1/4"	117 1/4"	117 1/4"	118 1/4"	119"	118"	118	118 1/4"	118 1/4"
Interior Height (crowned ceiling)	77"	77"	77"	77"	78"	78"	77"	77"	77"
Fresh Water Capacity (gals)*	32	32	32	26	32	32	26	26	32
Gray Wastewater Capacity (gals)	15	15	15	15	24	24	15	15	15
Black Wastewater Capacity (gals)	9	9	9	9	24	24	9	9	9
Sleeping Capacity	2-3	4-5	3-4	3-4	5-6	7-8	4-6	5-6	3

*Includes water heater. The weights of mandatory options are included in the UWV listed above, but optional packages are not included. See weight information details on the back of this brochure.

AR-ONE 7' WIDE TRAVEL TRAILER & TOY HAULER

Lightweight travel trailer floorplans are as good as they get with AR-ONE 7' wides. These durable, entry-level campers are value-priced, but feature-packed! A 2-year limited warranty, and quality amenities such as honey-glazed cherry wood cabinetry and Denver Mattress® brand quilted bunk mats, are just a few. There's a lot to see in a small, lightweight package. The AR-ONE line ensures you'll have an enjoyable camping experience. Find your perfect model today!

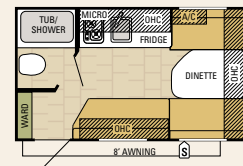

14RB | AR-ONE

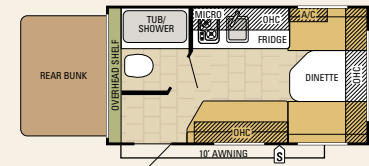

15RB | AR-ONE

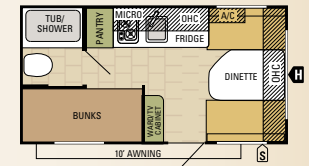

16BH | AR-ONE

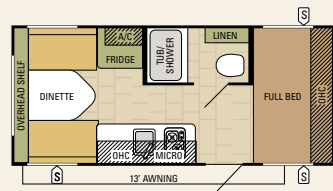

17RD | AR-ONE

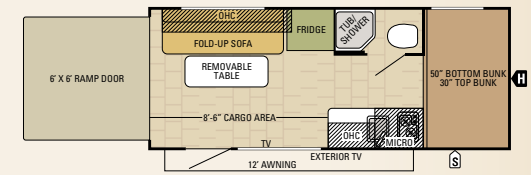

17TH | AR-ONE TOY HAULER

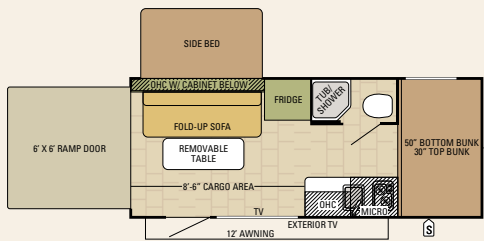

17XTH | AR-ONE TOY HAULER

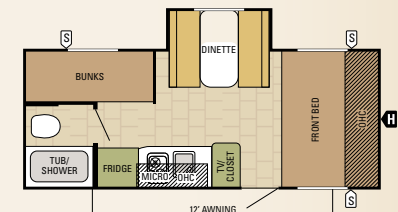

18BHS | AR-ONE

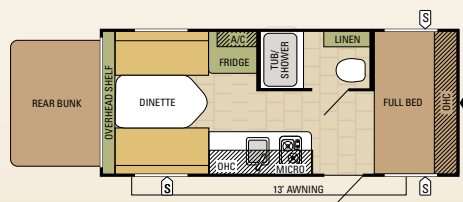

18FB | AR-ONE

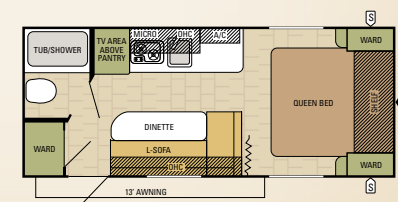

18QB | AR-ONE

AR-ONE MAXX 8' WIDE TRAVEL TRAILER





Standard queen bed shown.



STEP UP TO LIGHTWEIGHT LIVING. YOUR HOME AWAY FROM HOME.

LIVING ROOM.

A variety of slideroom floorplans allow for spacious living rooms. The medium LED TV is optional. Convertible dinette and carpet are standard features, while upgraded window treatments and pleated shades are included in our optional Deluxe Package.

KITCHEN.

This flush-mounted 6 cu. ft. refrigerator, 3-burner cooktop, high-rise kitchen faucet, honey-glazed cherry cabinetry and strong ball-bearing drawer guides are standard.

BEDROOM.

Select models come with an ultra plush Denver Mattress® bunk mat, wardrobe storage and bunk beds. With optional Deluxe Package, a tasteful bedspread and pillows are included.

STANDARD FEATURES.

The scissor jack pictured here is safe and easy to operate. See page 11 for a list of some of the standard features and optional equipment.

AR-ONE MAXX 8' WIDE TOY HAULER



26HR Toy Hauler with Pecan interior.



A convenient and easy-to-operate power awning with LED light strip is standard on MAXX models.



Toy haulers come with outside speakers in the Deluxe Package.



This optional fuel fill tank and nozzle in the Performance Package is a must for ATV users and other motorsports hobbyists.



An outside shower in the Deluxe Package features hot and cold faucets along with a retractable shower wand.

POPULAR STANDARDS

- 5/8" Main floor decking
- Crowned truss roof rafters on 16" centers with 3/8" WALK ON decking
- Magnum Roof System - 50% Stronger
- 81" Interior ceiling height
- 48-Gallon fresh water capacity
- 13,500-BTU A/C
- Cable TV prep
- Digital antenna (TV/FM)
- Galvanized steel wheel wells
- Three-toned exterior metal
- 6 cu. ft. flush-mount refrigerator
- Ball-bearing drawer guides, 50-lb. capacity with full-drawer extension
- High-rise kitchen faucet
- Ultra plush Denver Mattress® bunk mats

CUSTOMER CONVENIENCE PACKAGE (MANDATORY)

SHOW STOPPER PACKAGE (MANDATORY)

DELUXE PACKAGE

- Electric tongue jack
- Exterior speakers
- Outside shower
- Black tank flush
- Winterize hose
- Window treatments with pleated shades
- Sofa pillows
- Bedspread

POPULAR OPTIONS

- Medium LED TV
- Aluminum rims
- Oven
- 6-gallon gas/electric water heater
- Fan-Tastic® fan with vent cover in living room/kitchen
- Roof ladder
- Generator prep (26HR)
- Retractable screen wall (26HR)

- Climate Package: insulated, heated and enclosed underbelly; foil insulation in roof
- Performance Package (26HR): ToyLok®, 12 volt air station, glow-in-the-dark graphics, pump station with 30 gallon fuel tank, battery disconnect switch

POPULAR OPTIONS (19BHLE & 20BHLE)

- 3 cu. ft. gas/electric refrigerator
- 13,500 BTU A/C
- Extreme Package
- Climate Package

FOR FULL OPTIONS AND MORE STANDARD FEATURES GO TO starcraftcamping.com

SPECIFICATIONS	19BHLE	20BHLE	21FB	23FB	25BHS	26BH	26BHS	26HR	27BHS	28FBS	28QBS	30BHU
Unloaded Vehicle Weight (lbs.)	3373	3822	4183	4242	5522	4578	5822	6176	6566	6470	7549	7549
Dry Hitch Weight (lbs.)	400	400	490	525	685	500	705	700	635	615	895	895
Gross Vehicle Weight Rating (lbs.)	4400	5000	6000	6000	7500	6500	7500	8500	8500	8500	9500	9500
Cargo Carrying Capacity (lbs.)	987	1138	1777	1698	1938	1882	1618	2284	1894	1990	1911	1911
Exterior Length	22' 2"	23' 9"	25' 8"	26' 10"	29' 9"	29' 5"	30' 8"	31' 9"	33' 10"	33' 10"	36' 2"	36' 2"
Exterior Width	96"	96"	96"	96"	96"	96"	96"	96"	96"	96"	96"	96"
Exterior Height with A/C	126"	126"	126"	126"	132"	126"	136"	135 1/4"	135"	135"	134"	134"
Interior Height	81"	81"	81"	81"	81"	81"	81"	81"	81"	81"	81"	81"
Fresh Water Capacity (gals)*	48	48	48	48	48	48	48	48	48	48	48	32.5
Gray Wastewater Capacity (gals)	32.5	32.5	32.5	32.5	32.5	32.5	32.5	32.5	32.5	32.5	32.5	32.5
Black Wastewater Capacity (gals)	32.5	32.5	32.5	32.5	32.5	32.5	32.5	32.5	32.5	32.5	32.5	8-10
Sleeping Capacity	5-6	5-7	4	4.5	6-8	8-10	8-10	8-10	8-10	6-8	8-10	5-6

*Includes water heater. The weights of mandatory options are included in the UWW listed above, but optional packages are not included. See weight information details on the back of this brochure.

AR-ONE MAXX TRAVEL TRAILER & TOY HAULER

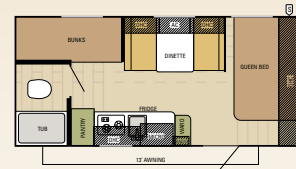

19BHLE | AR-ONE MAXX

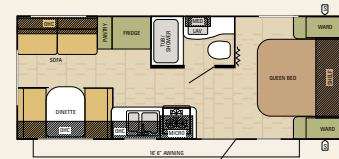

21FB | AR-ONE MAXX

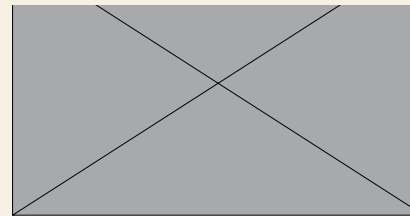

25BHS | AR-ONE MAXX

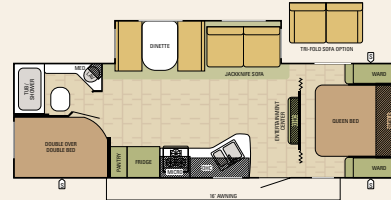

26BHS | AR-ONE MAXX

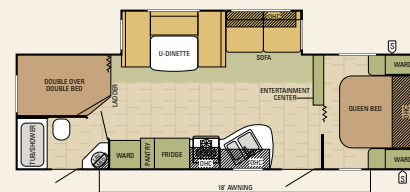

27BHS | AR-ONE MAXX

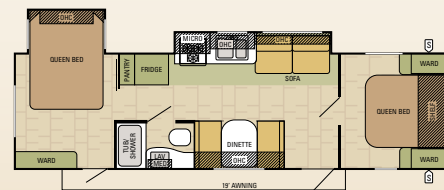

28QBS | AR-ONE MAXX

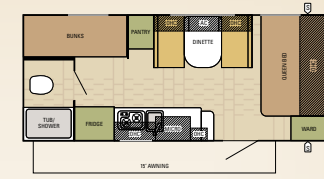

20BHLE | AR-ONE MAXX

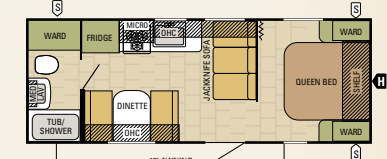

23FB | AR-ONE MAXX

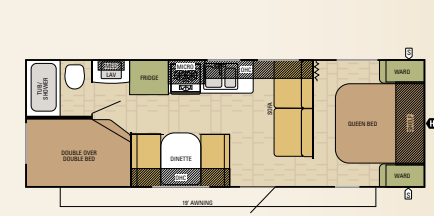

26BH | AR-ONE MAXX

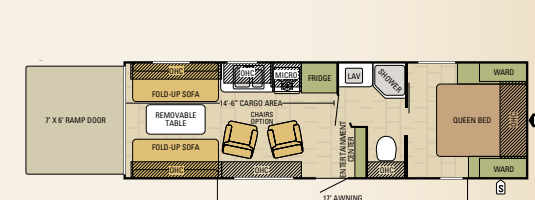

26HR | AR-ONE MAXX TOY HAULER

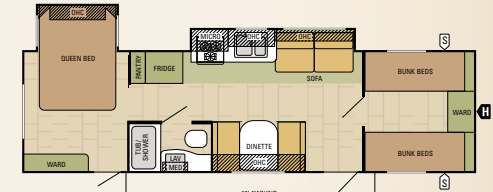

28FBS | AR-ONE MAXX

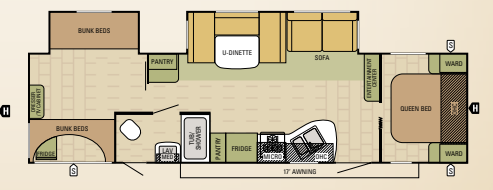

30BHU | AR-ONE MAXX

AR-ONE MAXX FIFTH WHEEL





FIFTH WHEEL LUXURY. WITHOUT THE LUXURY PRICE.



26BHS

LIVING ROOM.

Tastefully appointed interior living space includes upgraded furniture, plush carpet, fabrics and much more. See page 15 for more AR-ONE MAXX fifth wheel standards and options.

KITCHEN.

A 6 cu. ft. flush-mounted refrigerator and freezer with porcelain sink and 3-burner cooktop are standard on fifth wheel models. Notice the countertop, backsplash and large storage spaces.

BEDROOM.

This queen-size bed with upgraded mattress is a standard feature and will provide many nights of rest. Other fifth wheel floorplans include bunk beds for the children.

BATHROOM.

You'll find standard features like foot-flush toilet, oversized mirror, power bathroom vent, and a large 40" shower to name a few.

AR-ONE MAXX FIFTH WHEEL



26BHS with Pecan interior.



26BHS



Front storage area.



24RKS



FIFTH WHEEL FEATURES.

The AR-ONE MAXX fifth wheel is loaded with value from the optional LED TV in the bedrooms to the LED lighting throughout. An outside shower option is pictured here along with one-touch front leveling jacks. Heated tanks and plenty of storage are available on AR-ONE MAXX fifth wheels. For a list of the popular standards, packages, and options, please see page 15.



POPULAR STANDARDS

- 5/8" Main floor decking
- Crowned truss roof rafters on 16" centers with 3/8" WALK ON decking
- Magnum Roof System - 50% Stronger
- 48-Gallon fresh water capacity
- 19" Large plastic grab handle
- Digital antenna (TV/FM)
- Galvanized steel wheel wells
- Three-toned exterior metal
- 6 cu. ft. flush-mount refrigerator
- 96" interior ceiling height
- High-rise kitchen faucet
- Kitchen backsplash

CUSTOMER CONVENIENCE PACKAGE (MANDATORY)

SHOW STOPPER PACKAGE (MANDATORY)

- Spare tire with carrier
- Ducted A/C

- LED lighting for awning
- EZ-Store detachable cord
- Foot-flush toilet
- Wireless back-up camera prep
- Solar prep
- Kitchen backsplash
- Sleeper sofa

DELUXE PACKAGE OPTION

- Exterior speakers (2)
- Outside shower
- Black tank flush
- Winterize hose
- Porcelain toilet with foot-flush
- Window treatments with pleated shades
- Decorative light above dinette
- Sofa pillows
- Bedspread

POPULAR OPTIONS

- 6-gallon gas/electric DSI water heater
- 8 cu. ft. gas/electric refrigerator
- Medium LED TV
- Aluminum rims
- Climate Package: insulated, heated and enclosed underbelly; foil insulation in roof
- Climate Package with full foil wrap
- Glass shower door
- Oven
- Tri-fold hide-a-bed sofa
- Wireless back-up camera system

AR-ONE MAXX FIFTH WHEEL

Starcraft's all-new AR-ONE MAXX fifth wheel line provides luxuriously-appointed floorplans and together with more value in a lightweight, easy to tow unit. You'll find features like an optional Climate Insulation Package, standard sleeper sofa and much more. Find your perfect fifth wheel and camp in style.

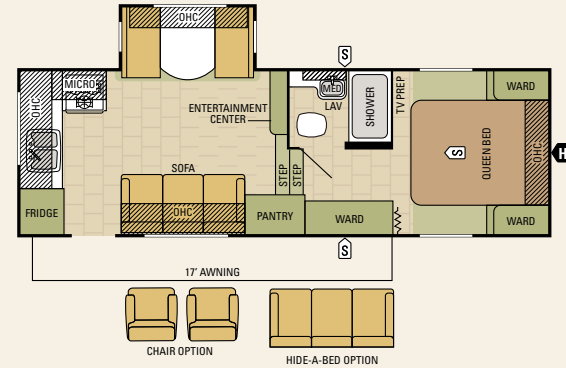

24RKS | AR-ONE MAXX FIFTH WHEEL

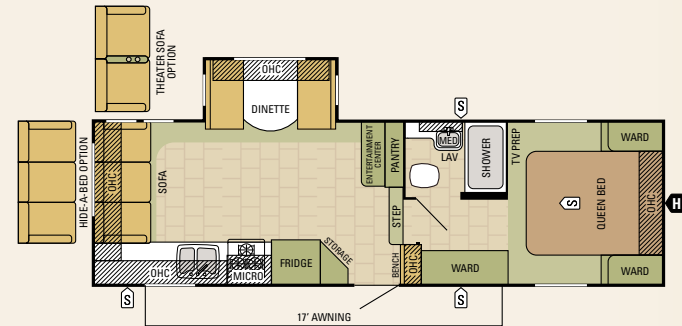

25RLS | AR-ONE MAXX FIFTH WHEEL

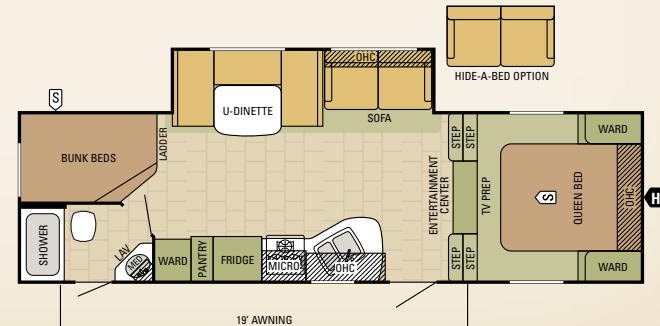

26BHS | AR-ONE MAXX FIFTH WHEEL

FOR FULL OPTIONS AND MORE STANDARD FEATURES GO TO starcraftcamping.com

SPECIFICATIONS	24RKS	25RLS	26BHS
Unloaded Vehicle Weight (lbs.)	6245	TBD	7060
Dry Hitch Weight (lbs.)	1200	TBD	1260
Gross Vehicle Weight Rating (lbs.)	8500	TBD	8900
Cargo Carrying Capacity (lbs.)	4400	TBD	1780
Exterior Length	27' 0"	28' 3"	30' 8"
Exterior Width	96"	96"	96"
Exterior Height with A/C	146"	146"	147"
Interior Height (bedroom)	79"	79"	70"
Interior Height (living area)	96"	96"	96"
Fresh Water Capacity (gals)*	48	48	48
Gray Wastewater Capacity (gals)	65	65	32.5
Black Wastewater Capacity (gals)	32.5	32.5	32.5
Sleeping Capacity	4-6	4-6	8-10

*Includes water heater. The weights of mandatory options are included in the UJV listed above, but optional packages are not included. See weight information details on the back of this brochure.

AR-ONE. THE FUTURE OF CAMPING JUST GOT BRIGHTER!



LANDED IN 1964. Starcraft is one of the oldest and most respected names in the RV industry. In fact, we've been around since 1903. Back then, we made our name building livestock tanks and other metal farm equipment. In the 1920's, we added a variety of boats to our product lineup. And in 1964, we entered—and revolutionized—the modern camping industry.



2-YEAR WARRANTY. The Starcraft warranty is a manufacturer's limited warranty. Each Starcraft is warranted to the original purchaser for 24 months from the original date of purchase against defects in materials and workmanship. For a copy of the limited warranty with full terms and conditions, ask your local Starcraft RV dealer.



GET MORE OF WHAT YOU NEED IN CYBERSPACE.

Explore more Starcraft RVs by visiting our world-class website. This advanced, digital-age-friendly site offers more product photo galleries, construction information, videos, the latest floorplans, specifications and other great features to assist you. Find your closest dealer, customer service info and more!

STARCRAFTCAMPING.COM

Eco advantage™

SAVING THE PLANET. The Starcraft EcoAdvantage™ is our company's commitment to protecting the environment. Through smart sustainability efforts, we're creating better ways to build better RVs using fewer or renewable natural resources. This is our commitment to you—to build a better RV so that we can do a better job of protecting our planet. Learn more at StarcraftRV.com/EcoAdvantage.

SEE YOUR LOCAL STARCRAFT DEALER:

STARCRAFT®

THE FUTURE OF CAMPING | pure and simple.

536 Michigan Street
Topeka, IN 46571 USA

Phone: (800) 945-4787
Web: starcraftcamping.com

FOR INTELLIGENT LIFE
FOLLOW US ON:



Unloaded Vehicle Weight (UWV): Sometimes referred to as "Dry Weight," UWV means the typical weight of this trailer as built at the factory. The UWV, as used in product literature and other promotional materials, does not include cargo, fresh water, propane, options or dealer-installed accessories. **Gross Vehicle Weight Rating (GVWR):** GVWR means the maximum permissible weight of the trailer, including the UWV plus passengers, personal items, all cargo, fluids, options, and dealer-installed accessories. The GVWR is equal to or greater than the sum of the UWV and the CCC. **Cargo Carrying Capacity (CCC):** CCC means the maximum weight of all passengers, personal items, food, fresh water, propane, tools, other cargo and dealer-installed accessories that can be carried by the trailer. CCC is equal to or less than GVWR minus UWV. The addition of options will decrease the CCC. **Hitch Weight (HW):** The hitch weight, as used in product literature and other promotional materials, does not include cargo, fresh water, propane gas, options or dealer-installed accessories. The addition of these types of items will either add to or subtract from the stated hitch weight. It is important for your safety and enjoyment that your tow vehicle be adequately sized and equipped to tow and handle the GVWR of the RV you select. Review weights and rating of your tow vehicle and consult a competent advisor for questions or advice. Whether you are new to RVing or a veteran, get a feel for the performance of your tow vehicle before heading out on the roadways. When you tow an RV, you must drive differently than when you drive a single vehicle. Practice hooking up, driving, backing up and braking in a safe environment or seek out professional instruction. Starcraft affixes a weight label to each RV which lists weight information for that vehicle. See specifications chart on the respective pages of this brochure.

All information contained in this brochure and on the Starcraft RV website is the latest available and is correct to the best of our knowledge at the time of publication approval. Starcraft reserves the right to make changes and to discontinue models without notice or obligation. Photography may show optional equipment or props used for decoration purposes only. RVs built for sale in Canada may differ to conform to Canadian codes. Check with your Starcraft dealer for the latest in specifications, standard and optional equipment. 01/16
© 2016 STARCRAFT RV, INC.